

# Revolving – Self-closing



## Frameless Cabinet and Door Specification (european styled)

Please note that the cabinet bottom has to be positioned according to the dimensions indicated in the drawing.

Door thickness 19.1 mm (3/4"). All tolerances  $\pm .5$  mm ( $\pm .02$ ").

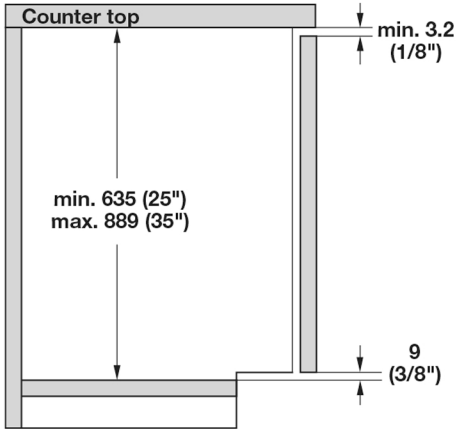

## Face Frame Overlay Cabinet and Door Specification

To fold the doors inside the cabinet, there has to be a gap between the door and the upper lower frame (rails) of 2.39 mm (3/32"). The upper and lower rails may have to be shortened compared to the standard rails of the cabinet. All tolerances  $\pm .5$  mm ( $\pm .02$ ").

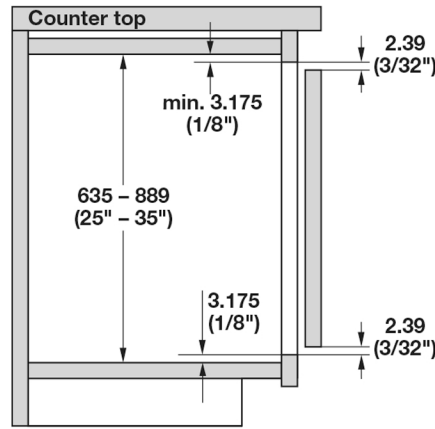

## Face Frame Inset Cabinet and Door Specification

Please note that the cabinet bottom must be positioned according to the dimensions indicated in the drawing.

Door thickness 19.1 mm (3/4"). All tolerances  $\pm .5$  mm ( $\pm .02$ ").

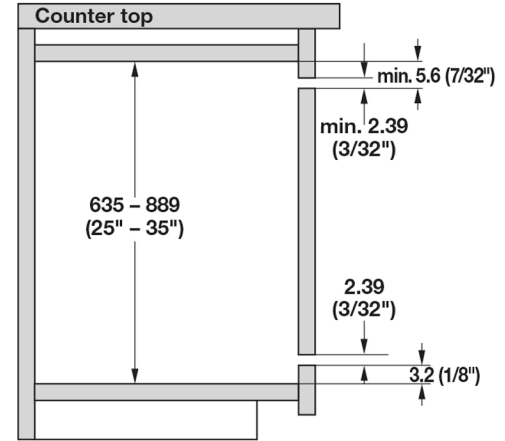

## Frameless Cabinet Bottom (european styled)

For different door widths, ensure that right door is wider. Fitting can be used with 16 mm (5/8") and 19 mm (3/4") side wall thickness. Door thickness 19.1 mm (3/4"). Dimension X has to be min. 427 mm (16 13/16") for side wall thickness 15.9 mm (5/8") and min. 424 mm (16 11/16") for side wall thickness 19.1 mm (3/4"). All tolerances  $\pm .5$  mm ( $\pm .02$ ").

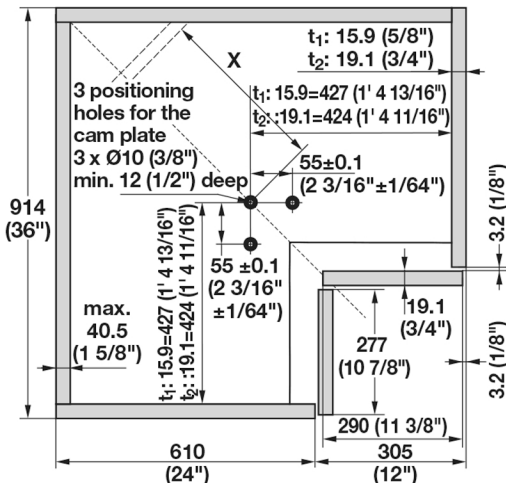

## Face Frame Overlay Cabinet Bottom

For different door widths, ensure that right door is wider. Note that the drilling dimensions are from the inner edge of the frame. Add your dimension from that point to the inner edge of the side wall in order to get the drilling dimension from the inner edge of the side wall. Use door bumpers with 3 mm (1/8") thickness. All tolerances  $\pm .5$  mm ( $\pm .02$ ").

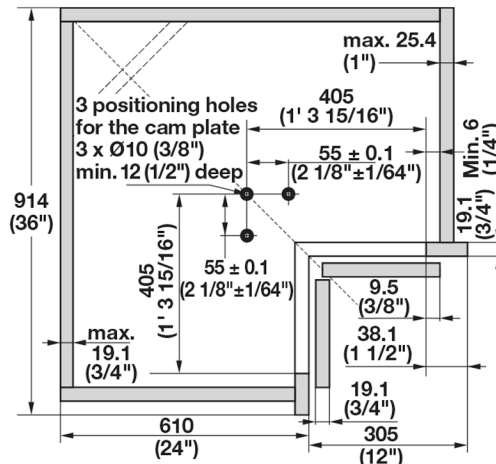

## Face Frame Inset Cabinet Bottom

For different door widths, ensure that right door is wider. Note that the drilling dimensions are given from the inner edge of the frame. Add your dimension from that point to the inner edge of the side wall in order to get the drilling dimension from the inner edge of the side wall. Door thickness 19.1 mm (3/4"). All tolerances  $\pm .5$  mm ( $\pm .02$ ").

